

Catalog No. Description List

**ITT MARLOW "ARGONAUT" PUMPS - THREE PHASE**

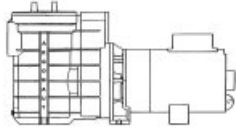

34-140-3050	1/2 Hp Marlow Argonaut Pump - 208-230/460V - 3 Phase	460.00
34-140-3075	3/4 Hp Marlow Argonaut Pump - 208-230/460V - 3 Phase	483.00
34-140-3100	1 Hp Marlow Argonaut Pump - 208-230/460V - 3 Phase	513.00
34-140-3150	1 1/2 Hp Marlow Argonaut Pump - 208-230/460V - 3 Phase	583.00
34-140-3200	2 Hp Marlow Argonaut Pump - 208-230/460V - 3 Phase	684.50

**GULF "POWER TECH" PUMPS - MAX RATED**

\* ETL Approved "Power Tech" Series \* Noryl® Body - Brass Reinforced Noryl® Impeller  
 \* 2" Suction & Discharge \* 110 Cubic Inch Capacity Trap With Lexan Lid

34-250-1601	3/4 Hp Max-Rated Power Tech Pump - 115/230V	383.50
34-250-1801	1 Hp Max-Rated Power Tech Pump - 115/230V	403.00
34-250-2201	1 1/2 Hp Max-Rated Power Tech Pump - 115/230V	430.50
34-250-2601	2 Hp Max-Rated Power Tech Pump - 115/230V	505.50

**GULF "POWER TECH" - FULL RATED**

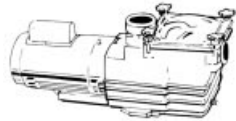

34-250-1400	1/2 Hp Full-Rated Power Tech Pump - 115/230V	383.50
34-250-1600	3/4 Hp Full-Rated Power Tech Pump - 115/230V	403.00
34-250-1800	1 Hp Full-Rated Power Tech Pump - 115/230V	430.50
34-250-2200	1 1/2 Hp Full-Rated Power Tech Pump - 115/230V	505.50
34-250-2600	2 Hp Full-Rated Power Tech Pump - 115/230V	572.00

**GULF "POWER TECH" - TWO-SPEED - FULL RATED**

34-250-1602	3/4 Hp 2-Speed Power Tech Pump - 115V	525.00
34-250-1802	1 Hp 2-Speed Power Tech Pump - 230V	535.50
34-250-2202	1 1/2 Hp 2-Speed Power Tech Pump - 230V	589.00
34-250-2602	2 Hp 2-Speed Power Tech Pump - 230V	730.50

**GULF "POWER TECH" - FULL RATED - LIQUID ENDS ONLY**

35-250-1400	1/2 Hp Full-Rated Liquid End (Pump Less Motor)	225.00
35-250-1600	3/4 Hp Full-Rated Liquid End (Pump Less Motor)	225.00
35-250-1800	1 Hp Full-Rated Liquid End (Pump Less Motor)	225.00
35-250-2200	1 1/2 Hp Full-Rated Liquid End (Pump Less Motor)	225.00
35-250-2600	2 Hp Full-Rated Liquid End (Pump Less Motor)	225.00

**GULF "POWER TECH II" SPA & ABOVEGROUND PUMPS - MAX RATED**



\* Horizontal Pump For Flooded Suction  
 \* Order Trap Assembly And Union Sets Separately

34-250-0014	1/2 Hp Max-Rated "Power Tech II" Pump - 115V	206.00
34-250-0016	3/4 Hp Max-Rated "Power Tech II" Pump - 115V	212.00
34-250-0018	1 Hp Max-Rated "Power Tech II" Pump - 115V	226.50